

Pattern Select Switch Circuit (PWR Mode Switch)

CIRCUIT DESCRIPTION

The ECM memory contains the shift programs for the NORMAL and POWER patterns, 2 position, L position and the lock-up patterns. Following the programs corresponding to the signals from the pattern select switch, the park/neutral position and other various sensors, the ECM switches the solenoid valves ON and OFF, and controls the transmission gear change and the lock-up clutch operation.

WIRING DIAGRAM

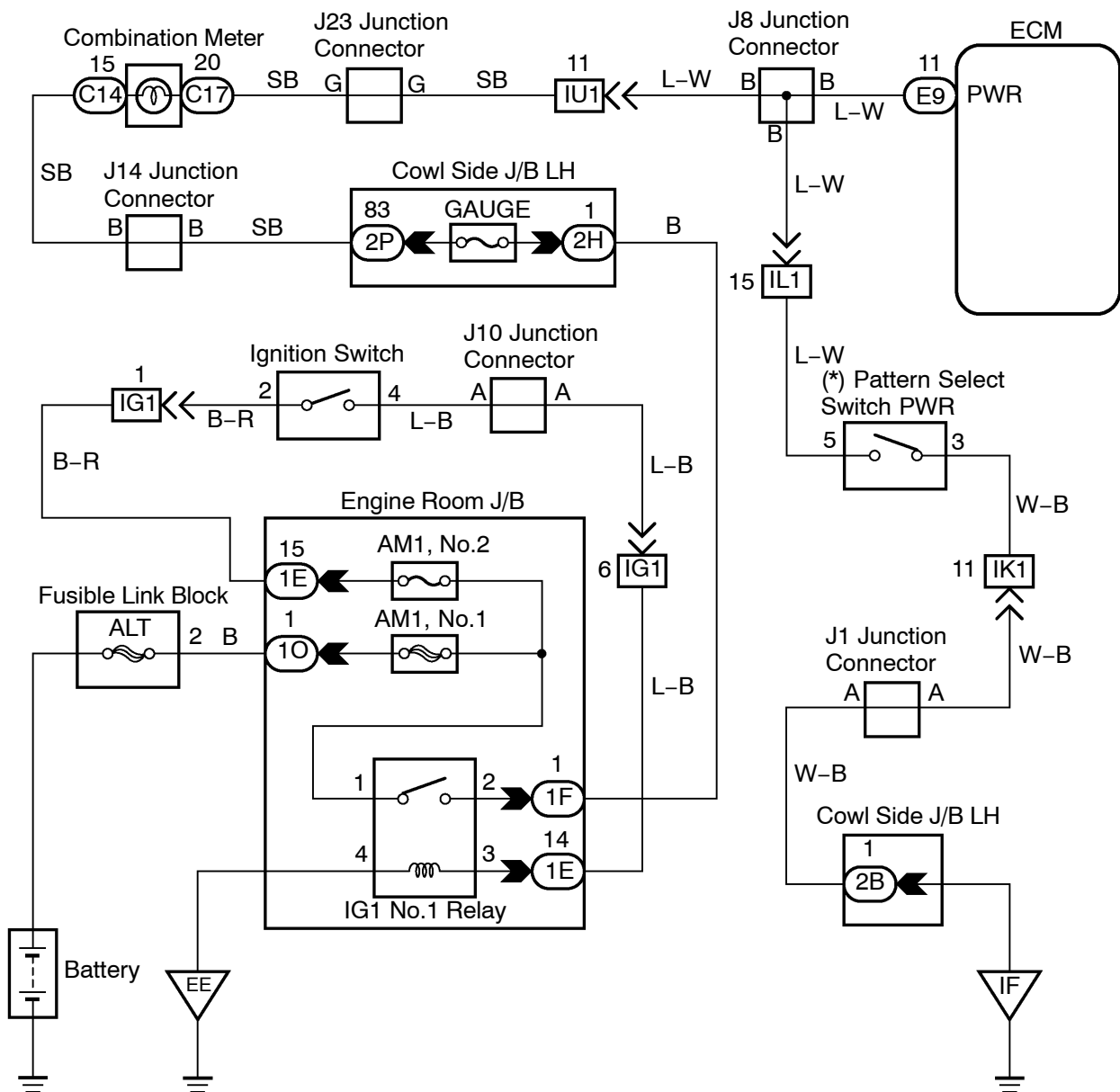

(*) Pattern Select Switch (PWR Mode Switch)

When the Pwr mode switch is pushed in, the switch contact is made and the PWR mode is selected.

To cancel the PWR mode, push the PWR mode switch once again.

INSPECTION PROCEDURE

1 Check PATTERN SEL SW signal.

When using LEXUS hand-held tester:

PREPARATION:

- (a) Connect a LEXUS hand-held tester to the DLC3.
- (b) Turn the ignition switch ON and LEXUS hand-held tester main switch ON.

CHECK:

Read the PATTERN SEL SW signal on the LEXUS hand-held tester.

OK:

Pattern select switch	PATTERN SEL SW signal
PWR	ON
NORM	OFF

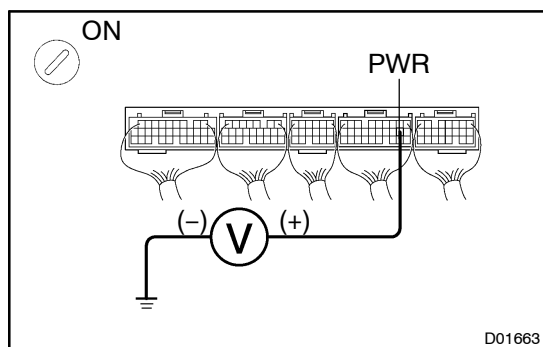

When not using LEXUS hand-held tester:

PREPARATION:

Turn the ignition switch ON.

CHECK:

Measure voltage between terminal PWR of ECM and body ground when the pattern select switch is set to the PWR (POWER) position and NORM (NORMAL) position.

OK:

Pattern select switch	Voltage
PWR	Below 1.5 V
NORM	10 ~ 14 V

HINT:

The ECM uses the normal pattern signal if the PWR signal is not input.

OK

Proceed to next circuit inspection shown on matrix chart (See page [DI-179](#)).

NG

2

Check pattern select switch.

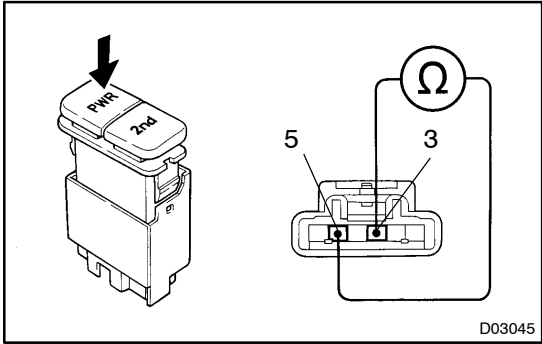

PREPARATION:

Disconnect the pattern select switch connector.

CHECK:

Check continuity between terminals 3 and 5 of pattern select switch connector when the select switch is set to PWR and NORM positions.

OK:

Pattern select switch	Specified condition
PWR	Continuity
NORM	No continuity

NG

Replace the pattern select switch.

OK

3

Check harness and connector between battery and pattern select switch, pattern select switch and ECM (See page [IN-33](#)).

NG

Repair or replace the harness or connector.

OK

**Check and replace the ECM
(See page [IN-33](#)).**